

Area a basso rischio "C" frequenza settimanale 6 g./set.		Mq 1064,05
Area a medio rischio "B" frequenza settimanale 7 g./set. con ripasso pomeridiano		Mq 818,49
Area a medio rischio "B1" frequenza settimanale 5 g./set. con ripasso pomeridiano		Mq 1117,00
Area a medio rischio "B2" frequenza settimanale 5 g./set. con quattro ripassi giornalieri		Mq 45,50
Area ad assenza di rischio "D" frequenza settimanale 1 g./set.		Mq 263,86
Area ad alto rischio "A" frequenza settimanale 7 g./set. con ripasso pomeridiano		Mq 439,30

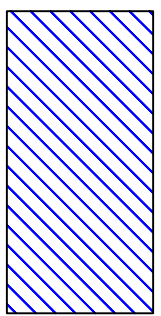
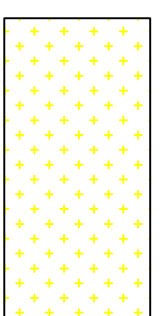
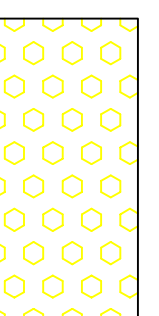
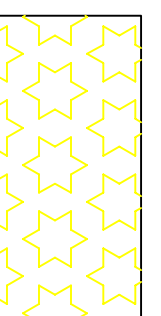
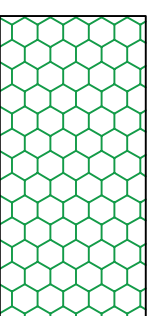
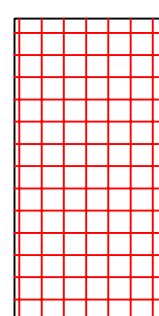
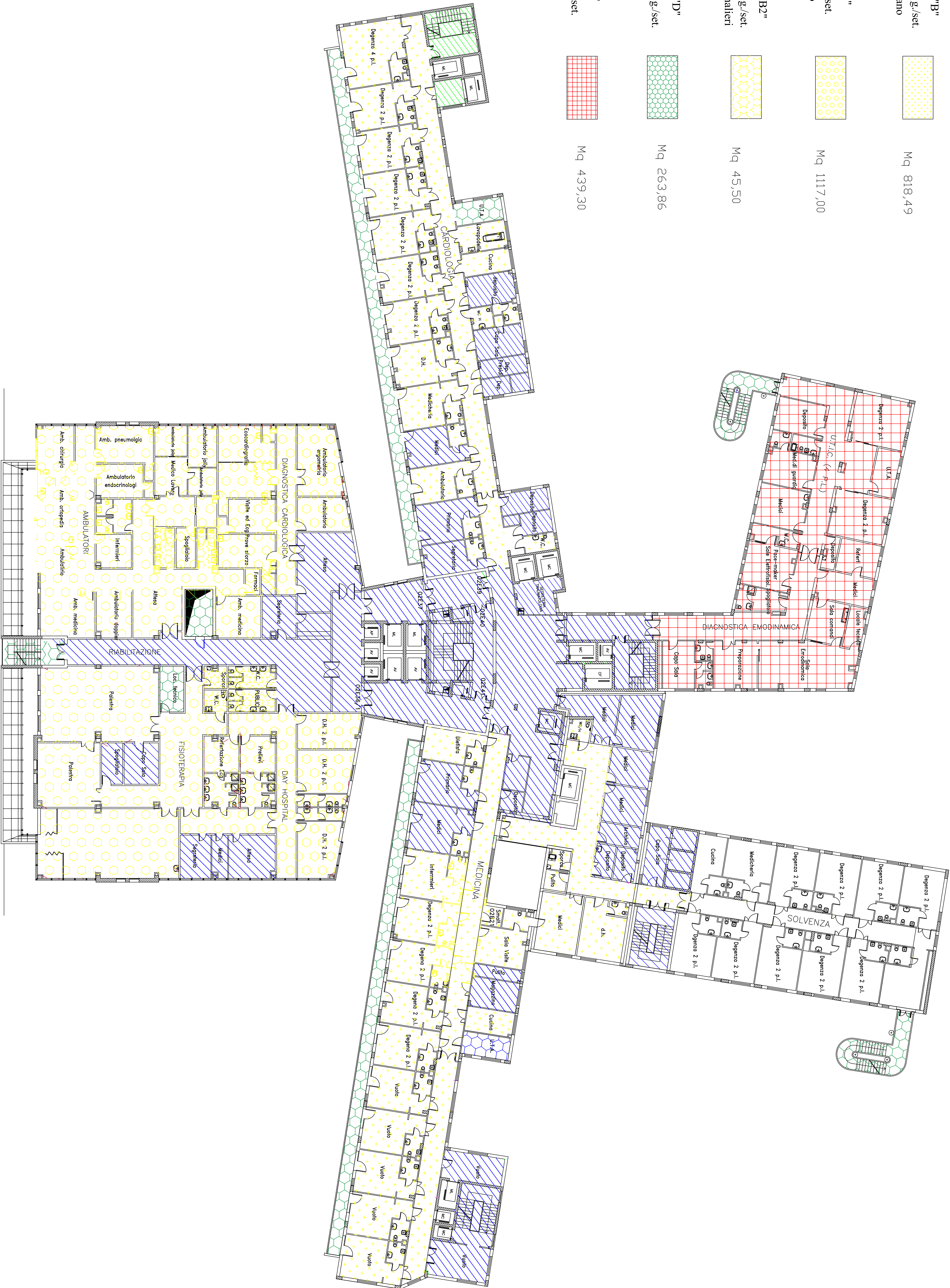

Pianta Secondo - Planimetria classificazione Aree e Frequenze